

# Opening this Fall: New Homeless Shelter for Men



NORTH SIDE HOUSING  
AND SUPPORTIVE SERVICES

Fact Sheet

## Men in Chicago Face a Drastic Shortage of Shelter Beds

In the last decade, the Point in Time Count (PIT) has consistently found that close to 5,000 Chicagoans experience homelessness on any given night. This number does not include the massive increase in homelessness from new-arrivals, nor people living doubled-up. In 2023 the PIT found that 68% of people experiencing homelessness were men. **Despite this reality, only 750, or 22%, of the 3,500 shelter beds in the city are available for single men.**



Nearly 7 of 10 people experiencing homelessness in Chicago are men



Just over 2 of every 10 shelter beds are able to be used by single men

## A Brand New Shelter to Help Unhoused Men

In September 2022, the City of Chicago Department of Housing (DOH) launched a new program to partner with operators of existing homeless shelters and create new, non-congregate shelters for people experiencing homelessness. **North Side Housing and Supportive Services** identified a vacant, single-story medical building in Rogers Park, and worked for months with architects, experts in trauma-informed care, city staff, and Alderwoman Maria Hadden to develop a proposal that would provide emergency housing and supportive services for single men. The result was a 10,000 square-foot, single-story shelter that will provide emergency housing for up to 70 men every night of the year.

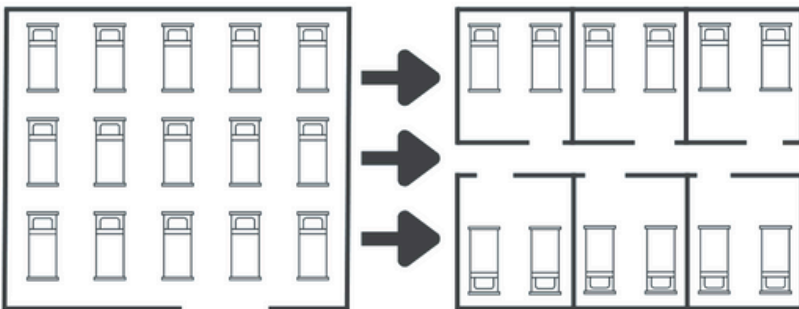

### **Congregate**

shelters are facilities with large open spaces, such as schools and churches, that accommodate multiple individuals or families in shared living and sleeping areas.

### **Non-congregate**

shelters provide more privacy. Individuals or families have their own living space, or a shared living space with one, two, or three other people, which can include hotels and dormitories.

**DOH approved the project in March, with the total development cost estimated to be \$7 million. To date, this is the only shelter to be approved for construction under the new program.** Construction started in April, and the trauma-informed shelter is expected to open before the end of the year. Everything in the interior will be new: the walls and floors, a commercial kitchen, HVAC system, laundry room, a large shower/bathroom, and a medical exam room. The non-congregate floor plan will be similar to a college dorm. Two men will live in each of the 35 sleeping rooms, providing much more privacy than the traditional congregate shelter.

# What Does it Mean for the Shelter to be Trauma-Informed?

The shelter will be the first of its kind in Chicago, and is expected to serve 250 men each year. **Every aspect of the shelter was designed with the intention of helping residents heal from the trauma of living outside and in the parks, reducing the amount of time in the shelter, and transitioning into long-term, stable housing.**

## Interior Design

Each sleeping room will provide shelter for up to two men and include a source of natural light, from either a window or skylight, to replicate the private, safe space of one's own home. The interior design of the bedrooms, corridors, and community spaces will be finished with lighting, paint colors, flooring patterns, and furniture that is comfortable and calming to residents.

## On-Site Services

Each resident will be assigned their own caseworker. In addition to helping residents complete housing applications and move into stable housing, caseworkers connect residents with critical services like mental health support, counseling, financial literacy classes, and job training. Residents will also receive three meals per day, free laundry, and on-site medical examinations.



**Non  
Congregate  
Living**



**Medical  
Examinations**



**Three Meals  
Per Day**



**Trauma  
Informed  
Design**



**Case  
Management**



**Housing  
Application  
Assistance**

# About North Side Housing and Supportive Services

Since 1983, we have been helping people find permanent solutions to end their homelessness in Chicago. We achieve this by providing emergency shelter, food, clothing, medical services, and case management to people experiencing homelessness. When our clients have the housing and resources to meet immediate needs, they are able to focus on their healing journey, make a plan to obtain long-term stability, and exit the shelter better positioned to leave homelessness behind for the rest of their life.

For more information about the project, contact:

- **North Side Housing and Supportive Services:** Peter Marchese, Board President, at [development@northsidehousing.org](mailto:development@northsidehousing.org)
- **Gensler Architects:** Sean McGuire, Senior Associate Architect, [Sean\\_McGuire@gensler.com](mailto:Sean_McGuire@gensler.com)
- **Department of Housing:** Meredith Muir, Program Manager, at [Meredith.muir@cityofchicago.org](mailto:Meredith.muir@cityofchicago.org)
- Matthew Stern, Senior Program Manager, at [matt.stern@cityofchicago.org](mailto:matt.stern@cityofchicago.org)
- **Department of Family and Support Services:** Kimberly Howard, Director, Homeless Services Division at [kimberly.howard2@cityofchicago.org](mailto:kimberly.howard2@cityofchicago.org)

Administrative and Daytime Support Services Center  
4410 N Ravenswood STE 101 Chicago, IL 60640  
P: (773)244-6401  
[www.northsidehousing.org](http://www.northsidehousing.org)

Executive Director: Duncan Ward

Emergency Shelter  
7464 N. Clark St.  
Will open in November, 2024